

15 Amp Micro ISO 280 Automotive Plug-In Relay PC781



FEATURES

- 15 Amps at 14 VDC Rating
- 80 Amp In Rush Current
- Miniature Package - 15.0 mm x 15.5 mm x 14.6 mm
- Reduced Footprint
- Micro 280 ISO Terminal
- Fully Automated Assembly
- RoHS Compliant

CONTACT RATINGS* 14 VDC

Contact Form	1 Form A Normally Open
Max Switching Current	80 Make 15 Break
Min Switching Current	1 A
Max Switching Voltage	16 VDC
Max Continuous Current	15 A

*At 20° C, 85% RH

CHARACTERISTICS

Operate Time	10 ms max
Release Time	10 ms max
Insulation Resistance	10 MΩ min.
With Stand Voltage	500 VAC, 1min. Between Coil and Terminal 500 VAC, 1 min. Between Homopolar Contact
Shock Resistance	1000 m/s ² 6 ms, Durability 1000 m/s ² 11 ms, Malfunction
Vibration Resistance	33 Hz; 44.1 m/s ² , Durability 33 Hz; 44.1 m/s ² , Malfunction
Power Consumption	1.091 W

CONTACT DATA

Material	Silver Alloy	
Initial Contact Resistance	50 mΩ max	
Service Life	Electrical	1 x 10 ⁵ Operations
	Mechanical	1 x 10 ⁶ Operations

CHARACTERISTICS Continued

Voltage Drop Between Terminals	200 mV max, 15 A
Operating Temperature	-30 to 100°C
Relative Humidity	30% to 85%
Weight	10 grams

ORDERING INFORMATION

Example:	PC781	-1A	-12	S	-R	-X
Model:	PC781					
Contact Form:	1A					
Coil Voltage:	12					
Enclosure:	S: Sealed					
Contact Material:	Nil: AgSnO₂					
Parallel Component:	R: Resistor (1.1 K, 1/4 W)					
RoHS Compliant:	-X					

Box Quantity: 500; Inner Box: 50

COIL DATA

Coil Voltage (VDC)		Resistance (Ohms ± 10%)	Must Operate Voltage Max (VDC)	Must Release Voltage Min. (VDC)	Coil Power (W)
Rated	Max				
12	16	132	7.5	1.0	1.091

NOTES:

The use of any coil voltage less than the rated voltage will compromise the operation of the relays.
 Must Operate Voltage is listed for test purposes only and is not to be used as design criteria.
 Pickup and release voltages are for test purposes only and are not to be used as design criteria.

DIMENSIONS Inches/mm

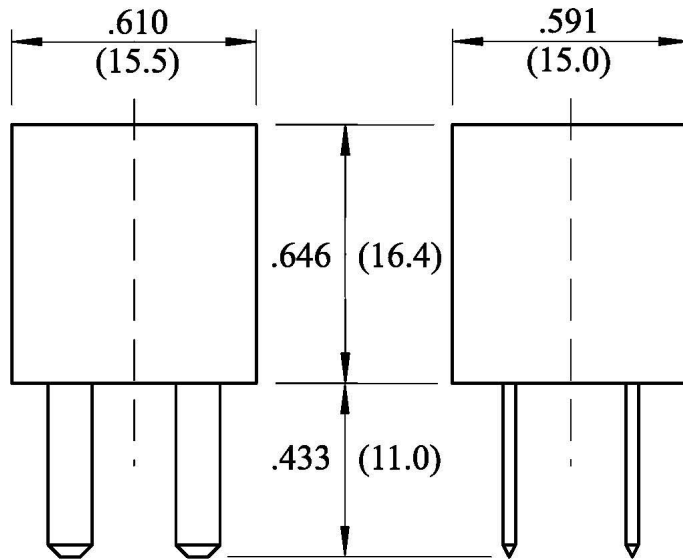

Relay

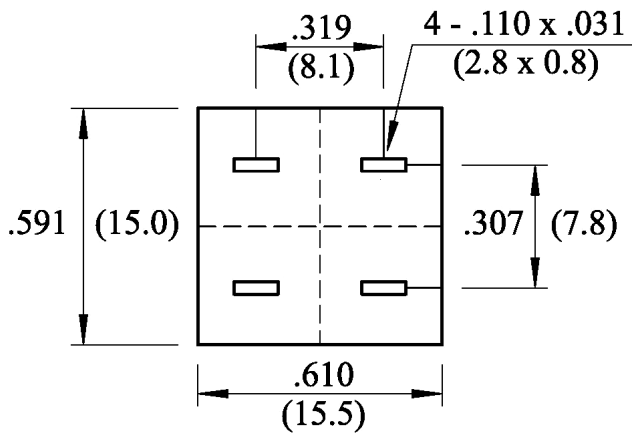

Terminal Layouts (Bottom View)

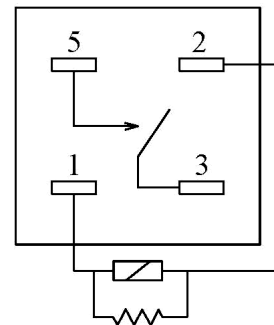

Wiring Diagrams