

150/100 Amp Automotive Plug-In / PCB Maxi ISO Relay

PC7150

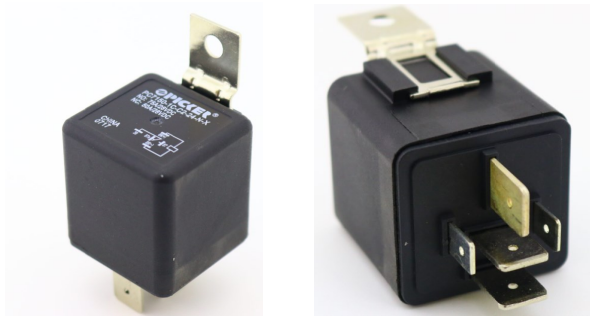

FEATURES

- Popular Maxi ISO Automotive Relay Footprint
- 1A and 1C Contact Forms Available
- Contact Switching Capacity up to 450 Amps
- 150 Amps Continuous Carrying Current
- Up to 125°C Operating Temperature
- Internal Diodes or Resistors Available
- Plain Case, Metal Mounting Bracket and PC Pins
- Sockets Available
- Lead Free and RoHS Compliant

CONTACT RATINGS 14 VDC at 25°C

Contact Form	1 Form A or 1 Form C	
	Normally Open	Normally Closed
Max Switching Current	Make 450 A ⁽¹⁾	Make 300 A ⁽¹⁾
	Break 150 A	Break 100 A
Max Continuous Current	150 A @ 25°C	100 A @ 25°C
	112.5 A @ 85°C	75 A @ 85°C
Max Switching Voltage	75 VDC	
Max. Switching Power	1800 W	
Minimum Load	0.5A @ 12 VDC	

CONTACT RATINGS 28 VDC at 25°C

Contact Form	1 Form A or 1 Form C	
	Normally Open	Normally Closed
Max Switching Current	Make 225 A ⁽¹⁾	Make 150 A ⁽¹⁾
	Break 75 A	Break 50 A
Max Continuous Current	75 A @ 25°C	50 A @ 25°C
	56.25 A @ 85°C	37.5 A @ 85°C
Max Switching Voltage	75 VDC	
Max. Switching Power	1800 W	
Minimum Load	0.5A @ 24 VDC	

CHARACTERISTICS

Operate Time	7 msec Typical
Release Time	2 msec Typical
Insulation Resistance	100 MΩ Min @ 500VDC
Dielectric Strength	50 Hz 1000 V Between Contact and Coil
	50 Hz 750 V Between Contacts
Shock Resistance	147 m/s ² 11 msec
Vibration Resistance	10-40 Hz Double Amplitude 1.5mm
Terminal Strength	30 N
Solderability	260°C for 5 seconds
Power Consumption	2.9 W

CONTACT DATA

Material	AgSnO ₂	
Initial Contact Resistance	100 MΩ Max @ 0.1 A, 6 VDC	
Service Life	Electrical	1 x 10 ⁵ Operations
	Mechanical	1 x 10 ⁷ Operations

CHARACTERISTICS Continued

Operating Temperature	-40°C to 125°C
Storage Temperature	-40°C to 155°C
Relative Humidity	85% at 40°C
Weight	60 grams

⁽¹⁾With current load applied for a maximum of 3 seconds at a maximum duty cycle of 10%.

ORDERING INFORMATION

Example:	PC7150	-1C	-C2	-12	C	-R	N	-X
Model:	PC7150							
Contact Form:	1A, 1C							
Case Style:	C: Plug-In; C2: Metal Bracket; P: PC Pins							
Coil Voltage:	12, 24, 48							
Enclosure:	C: Dust Cover							
Parallel Component:	Nil: None; D: Diode; R: Resistor							
Terminal Plating:	N: Nickel Plated Terminals Standard on all Plug In Models; Nil: PC PIN Version							
RoHS Compliant:	-X							

Resistor Values:
 6V - 180 ohm
 12V - 680 ohm
 24V - 2,700 ohm
 Diode: 1N4005

Box Quantity: 200; Inner Box: 100

COIL DATA

Coil Voltage (VDC)		Resistance (Ohms ± 10%)	Must Operate Voltage Max (VDC)	Must Release Voltage Min. (VDC)	Coil Power (W)
Rated	Max				
12	15.6	50	7.8	1.2	2.9
24	31.2	195	15.6	2.4	
48	62.4	794	31.2	4.8	

NOTES:

The use of any coil voltage less than the rated voltage will compromise the operation of the relays. Must Operate Voltage is listed for test purposes only and is not to be used as design criteria. Pickup and release voltages are for test purposes only and are not to be used as design criteria.

Dimensions are in mm, Inches are listed for reference only.

DIMENSIONS (inches/mm)

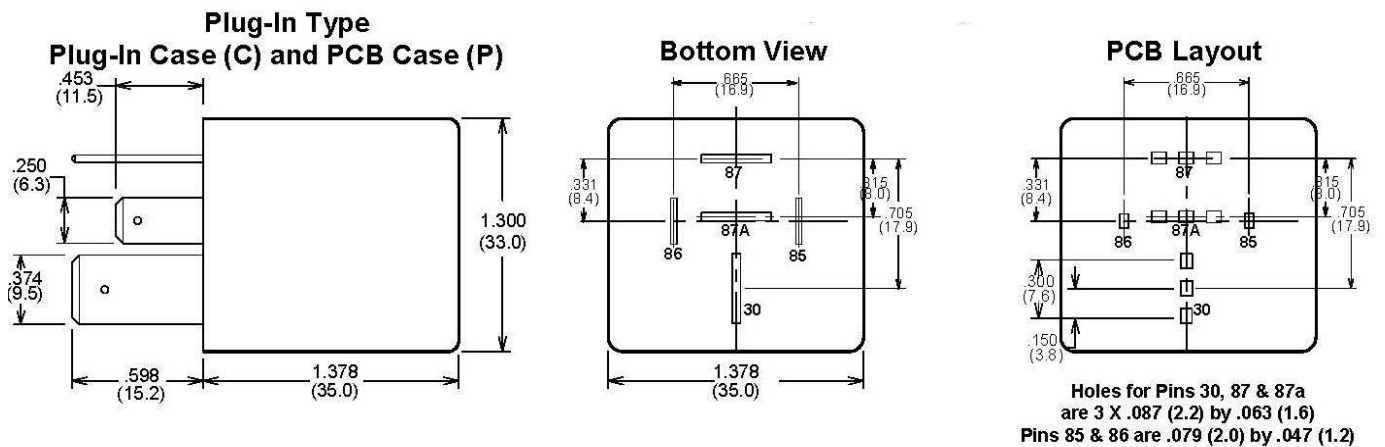

Metal Bracket Type

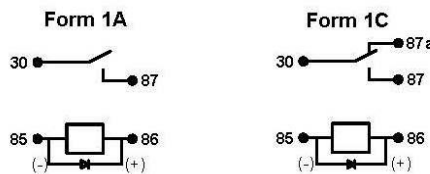
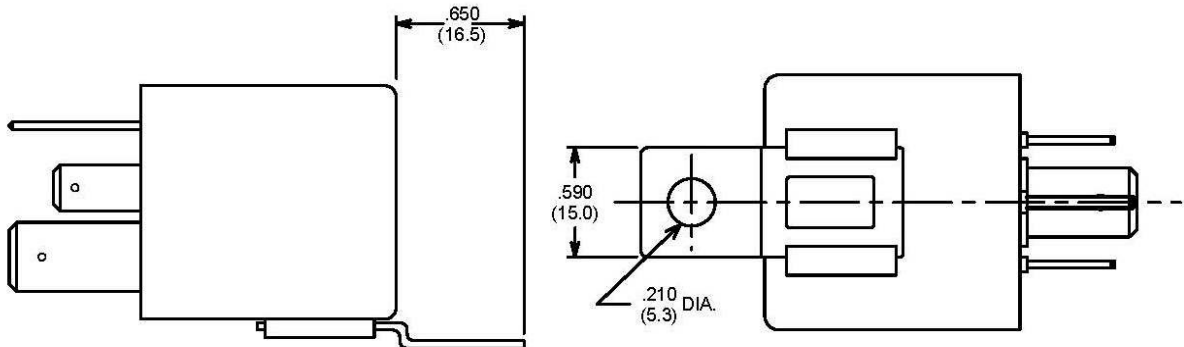

Wiring Diagrams

Notes:

Tolerances ± .010 unless otherwise noted
 Maximum make current refers to inrush of a lamp load