

COIL DATA

Coil Voltage		Coil Power - 2.8 W				Coil Power at Rated and Holding Voltage
		Resistance ohms ± 10%	Must Operate Voltage Max ⁽¹⁾ (VDC)	Must Release Voltage Min (VDC)	Holding Voltage ⁽²⁾ 36% of Coil Voltage (VDC)	
Rated	Max					
9	11.7	28.9	6.75	0.9	3.2	2.8 Watts / 363 mW
12	15.6	51.4	9.00	1.2	4.3	
24	31.2	205.7	18.0	2.4	8.6	

NOTES:

- The use of any coil voltage less than the rated voltage will compromise the operation of the relays.
- Must Operate Voltage is listed for test purposes only and is not to be used as design criteria.

- (1) To properly operate the relay, 100-125% of the Must Operate Coil Voltage must be applied for a minimum of 200 msec.
 (2) The Coil Holding Voltage may be used after applying the Rated Coil Voltage for a minimum of 200msec

DIMENSIONS (mm/inches)

Dimensions are in mm, Inches are listed for reference only.

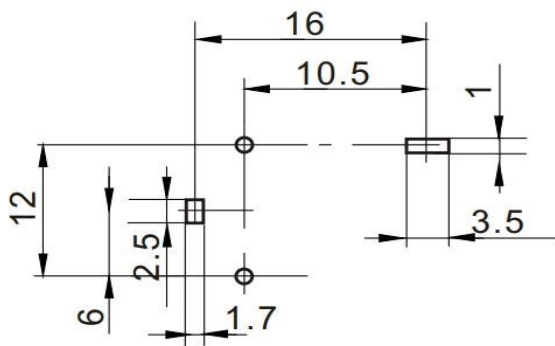
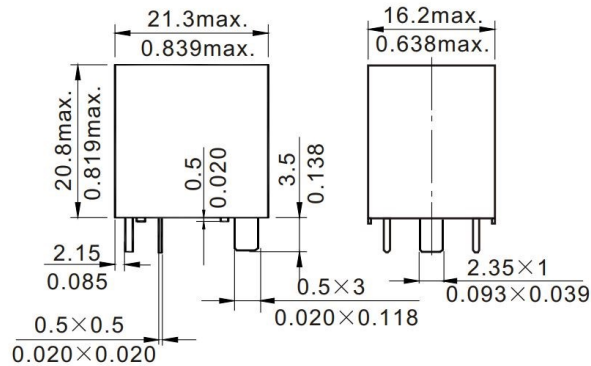

Mounting(Bottom view)

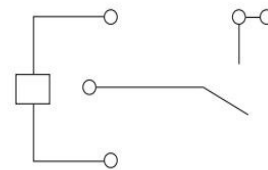

Wiring diagram (Bottom view)



3220 Commander Drive, Suite 102 Carrollton, TX 75006
 Sales: (972) 713-6272 (888) 997-3933 Fax: (972)735-0964

www.PickerComponents.com
 e-mail: sales@pickercomponents.com