



For Use With PC113-2C (2 Pole) Relay

**FEATURES**

- Pressure Clamp Screws
- Two Hold Down Cups Included
- Heat Stabilized Thermoplastic
- RoHS Compliant

**Socket Without Finger Safe Terminals**

Dimensions in mm

**Socket With Finger Safe Terminals**

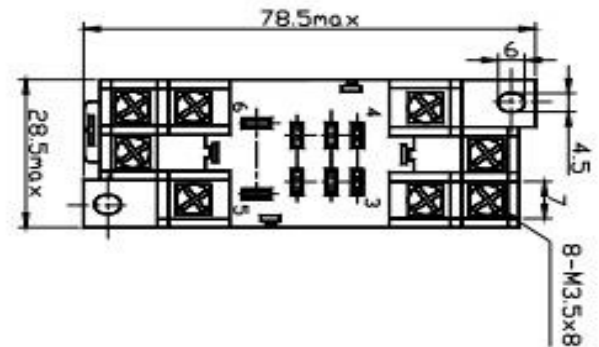
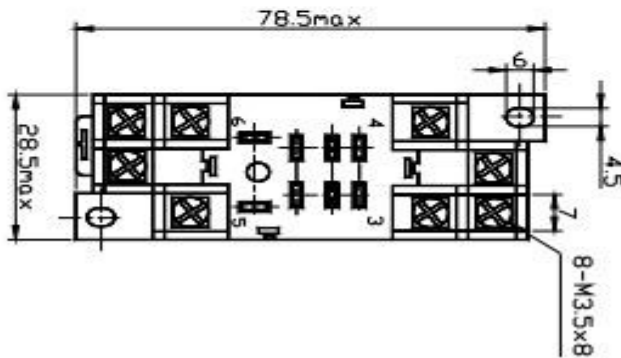
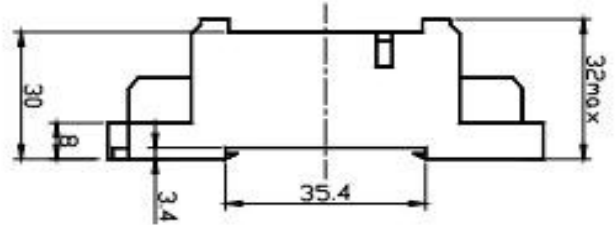
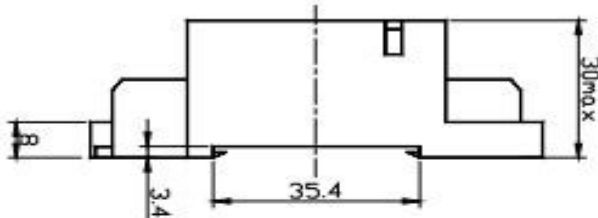

**Notes**

All Picker Components sockets have pressure clamp screws  
Fits standard 35mm Din Rail  
Tolerances +/- 0.010 unless otherwise noted

NOTES 1).Dimensions are in millimeters.

2).Inch equivalents are given for general information only.

**ORDERING INFORMATION**

| Part Number | Description  | Terminals     |
|-------------|--------------|---------------|
| SC113-2C-F1 | 8 Pin Socket | Open Terminal |
| SC113-2C-F2 | 8 Pin Socket | Finger Safe   |

**Hold Down Clip**

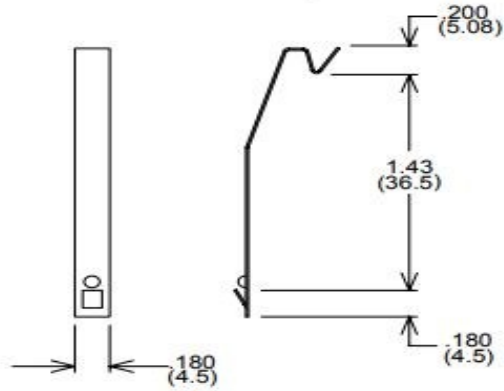

**Terminal Layout  
Top View**

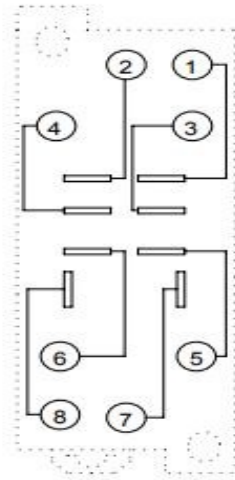

**Mounting Dimensions  
Top View**

