

40 Amp Micro ISO Automotive Plug In / PCB Relay

PC784



FEATURES

- Micro Size Plug-In Design
- 1A and 1C Contact Forms Available
- Contact Switching Capacity up to 105 Amps
- 35 Amps Continuous Carrying Current
- 125°C Operating Temperature
- Internal Diodes or Resistors Available
- Compatible with Socket SC782
- RoHS Compliant

CONTACT RATINGS 14 VDC at 25°C

Contact Form	1 Form A	1 Form C	
		Normally Open	Normally Closed
Max Switching Current	Make 120 A ⁽¹⁾	Make 190 A ⁽¹⁾	Make 60 A ⁽¹⁾
	Break 40 A	Break 35 A	Break 20 A
Max Continuous Current	40 A	35 A	20 A
Max Switching Voltage	28 VDC		
Max. Switching Power	560 W		
Minimum Load	0.1A @ 12 VDC		

⁽¹⁾With current load applied for a maximum of .5 seconds at a maximum duty cycle of 10%.

CHARACTERISTICS

Operating Time	10 msec Max
Release Time	10 msec Max
Insulation Resistance	100 MΩ Min at 500VDC
Dielectric Strength	500 V, 50 Hz Between Contacts
	500 V, 50 Hz Between Contact and Coil
Shock Resistance	Functional: 100 m/s ² , 11ms
	Survival: 1,000 m/s ² , 11ms
Vibration Resistance	10 Hz - 55 Hz Double Amplitude 1.5 mm
Terminal Strength	Push & Pull 100N
Power Consumption	1.5 W, 1.8 W

ORDERING INFORMATION

Example:	PC784	-1C	-12	S	-R	-X
Model:	PC784					
Contact Form:	1A, 1C					
Mounting Version:	Nil: Plug-In					
Coil Voltage:	12 (1.5W), 24 (1.8W)					
Enclosure:	C: Dust Cover , S: Sealed Case					
Coil Power:	Nil: (1.5W if 12V, 1.8W if 24V)					
Parallel Component:	Nil: None; D: Diode, R: Resistor					
RoHS Compliant:	-X					

Box Quantity: 1,000; Inner Box: 500

See SC782 for Available Sockets

Cross References

	Song Chuan	Picker Part
Series	871	PC784

CONTACT RATINGS 28 VDC at 25°C

Contact Form	1 Form A	1 Form C	
		Normally Open	Normally Closed
Max Switching Current	Make 60 A ⁽¹⁾	Make 45 A ⁽¹⁾	Make 30 A ⁽¹⁾
	Break 20 A	Break 15 A	Break 10 A
Max Continuous Current	20 A	15 A	10 A
Max Switching Voltage	28 VDC		
Max. Switching Power	560 W		
Minimum Load	0.1A @ 12 VDC		

CONTACT DATA

Material	AgSnO ₂	
Initial Contact Resistance	50 mΩ Max	
Service Life	Electrical	1 x 10 ⁵ Operations
	Mechanical	1 x 10 ⁶ Operations

CHARACTERISTICS Continued

Solderability	260°C, for 5s
Operating Temperature Range	- 40 to 125°C
Storage Temperature Range	- 40 to 155°C
Relative Humidity	35% ~ 85% (@ 40°C)
Weight	18g

COIL DATA

Coil Voltage (VDC)		Coil Resistance Ohms ± 10%		Resistance	Must Operate Voltage Max (VDC)	Must Release Voltage Min. (VDC)	Coil Power Consumption W
Rated	Max	Without Resistive suppression	With Resistive suppression				
12	16	96	84	680	7.2	1.2	1.5
24	32	320	286	2,700	14.4	2.4	1.8

Dimensions、 Wiring diagram、 Mounting(mm)

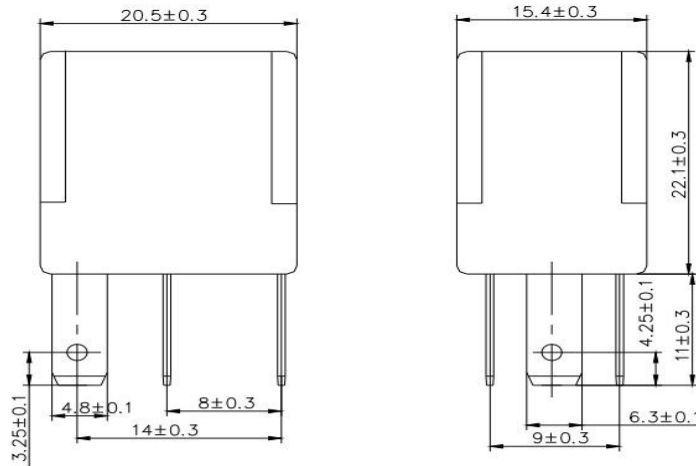

Dimensions

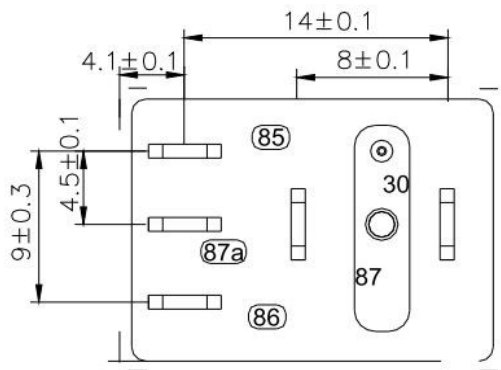

Mounting (Bottom view)

NOTE: A Form: Without 87a

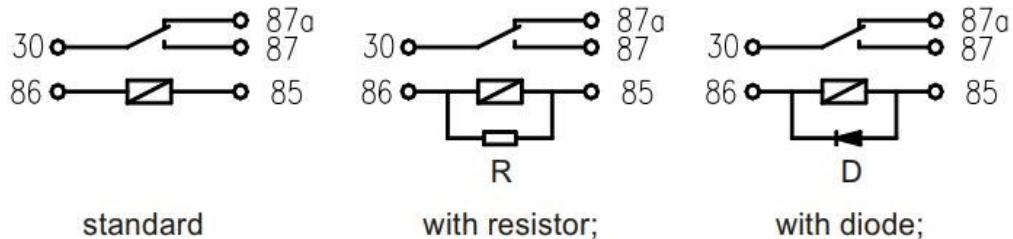

Wiring diagram (Bottom view)